

2298 LANSDOWNE RD  
13 UNIT TOWNHOME  
DEVELOPMENT

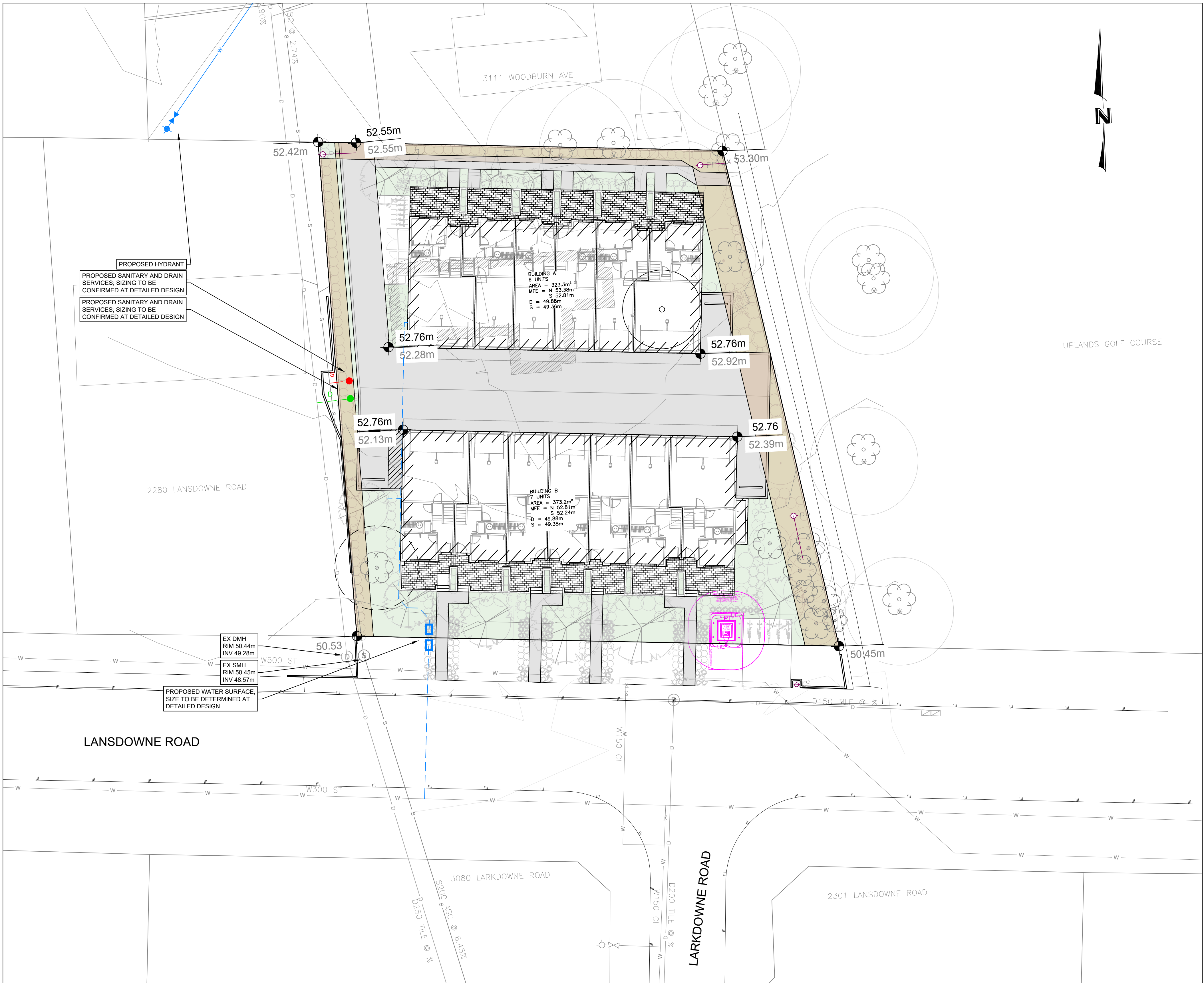

SITE PLAN  
SCALE 1:250

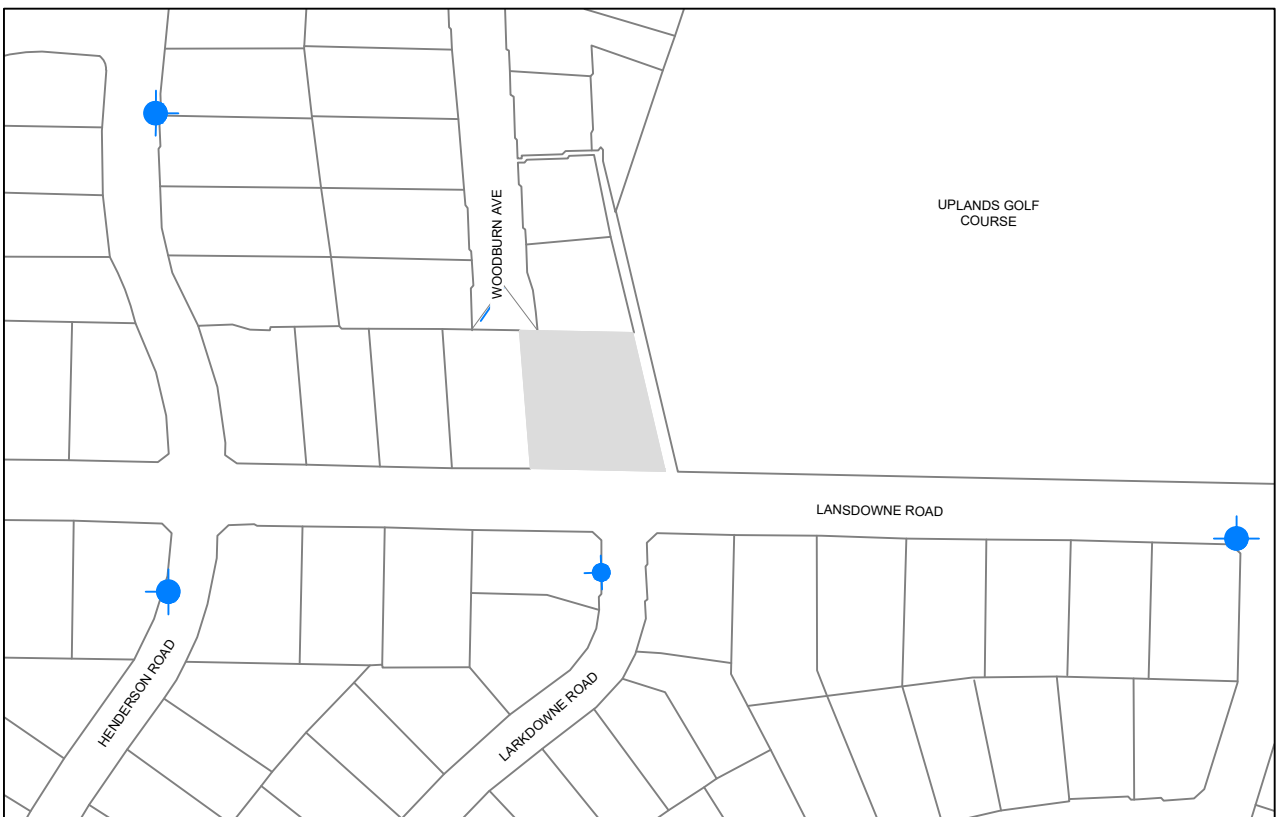

GENERAL LOCATION PLAN  
SCALE 1:2500  
CIVIC ADDRESS: 2298 LANSDOWNE ROAD  
LEGAL DESCRIPTION: LOT 16 PLAN 9210

BC  
1  
CALL  
1-800-474-6886

THE CONTRACTOR IS TO CALL B.C. ONE CALL, AND HAVE EXISTING U/G SERVICES STAKED PRIOR TO ANY CONSTRUCTION.



PRELIMINARY

ISLANDER  
ENGINEERING  
623 DISCOVERY STREET  
VICTORIA, B.C. V8T5G4  
PHONE 250.580.1200  
www.islandereengineering.com

CONFIRM UNDERGROUND LOCATIONS WITH UTILITY COMPANIES  THE LOCATION AND ELEVATION OF THE EXISTING UNDERGROUND INFRASTRUCTURE SHOWN ON THIS DRAWING MAY NOT BE ACCURATE OR COMPLETE. THE ACTUAL HORIZONTAL AND VERTICAL LOCATIONS MUST BE CONFIRMED PRIOR TO THE START OF ANY EXCAVATION.	LEGEND					REVISIONS		REVISIONS APPROVED						DESIGN APPROVED			DISTRICT OF OAK BAY		ISLANDER FILE #	2877							
	Existing Municipal Infrastructure					Drain	—D—	Curb	—C—	Concrete Box	☒	Valve	☒	5	REVISION # 1		REVISION # 2		REVISION # 3		Approved By	Date	Signed	2298 LANSDOWNE ROAD		MUNICIPAL DESIGN #	X
	Proposed Municipal Infrastructure					Ditch	—D—	Sidewalk	S/W	Wood Box	☒	Flush Valve	☒	6	Approved	Date	Signed	Approved	Date	Signed	Approved	Date	Signed	CONCEPTUAL SERVICING PLAN		REV. #	X
	Existing External U/G Utilities					Sewer	—S—	Manhole	☐	Catch Basin	☒	Hydrant	☒	4	Design Engineer			Design Engineer			Design Engineer			Manager of Development			
	Proposed External U/G Utilities					Water	—W—	Cleanout	☐	Culvert	☒	Reducer	☒	3													
	Street Lighting					Pole Mount	☒	Standard Mount	☒	Traffic Sign	☒	Silt Trap	☒	2													
	Post Top					Pedestrian Signal	☒	Traffic Signal	☒	Ctrl Monument	☒	Traverse Hub	☒	1	Manager of Development			Manager of Development			Manager of Development			Development Coordinator			